INFORMATION MEMORANDUM

구의 웰츠타워

서울시 광진구 자양로 116

MAR. 2023



BUILDING INFORMATION

Location | 서울시 광진구 자양로 116

건축 개요

대지면적	975.86py
연면적	10,115.97py
용도	업무시설(오피스텔,사무소), 제1,2종근린생활시설
규모	B5F / 19F(Retail 1F-5F)
세대수	398세대
주차대수	274대
준공년월	2015년 01월



SITE ANALYSIS

Site Info.

- 서울지하철 2호선 구의역 역세권
- 유동인구 월 평균 55,543명
- 직장인/주거지 밀집지역 (서울동부지방검찰청, 서울광진경찰서, 광진구청, 동서울우편집중국, KT수도권강북광역지사 등)

(반경 500m (구의1동) 기준)



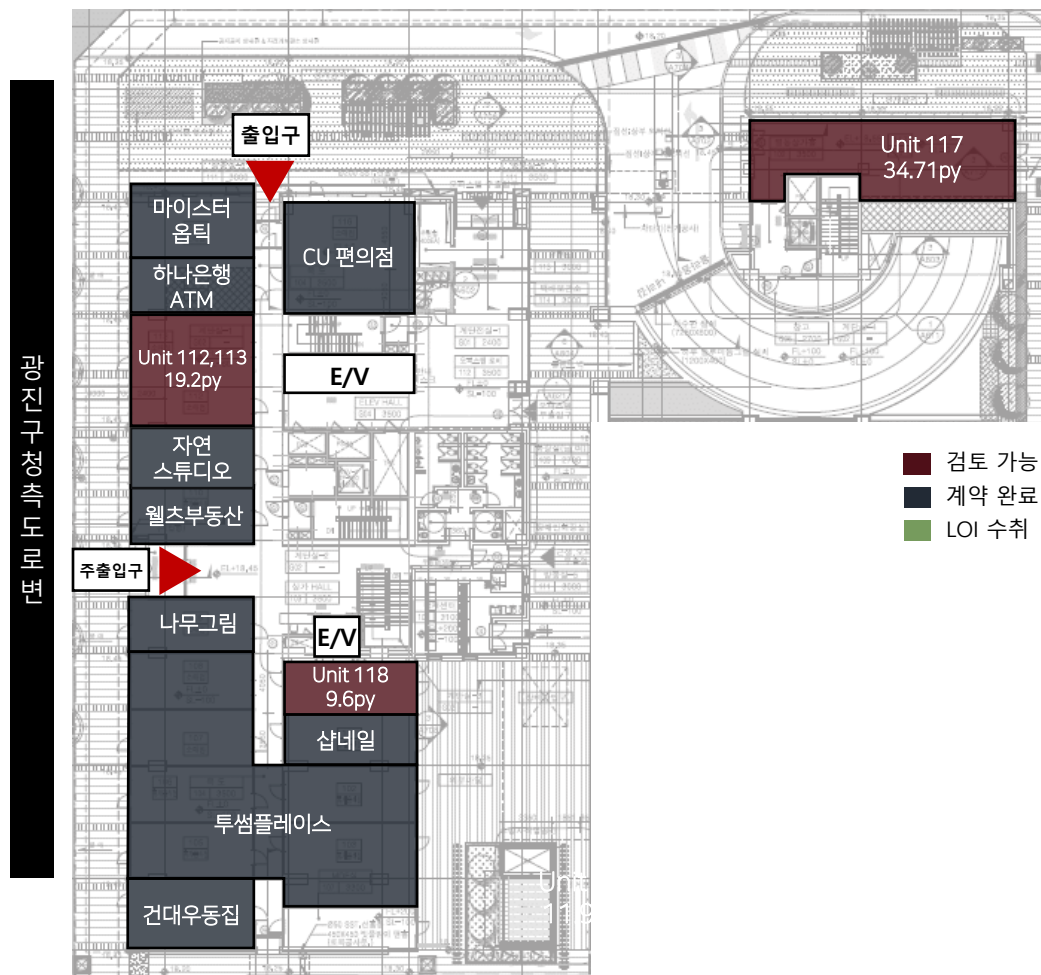

- 검토 가능
- 계약 완료
- LOI 수취

(단위: 평, 원)

FL	Unit	전용면적	보증금	임대료	관리비
1층	112, 113	19.2	71,000,000	7,100,000	470,000
1층	117	34.7	70,000,000	7,000,000	850,000
1층	118	9.6	17,000,000	1,700,000	240,000

THANK YOU

The depiction in the included photograph of any person, entity sign, logo or property, other than client and the property offered by Sweet Spot Co., Ltd. is incidental only, and is not intended to connote any affiliation, connection, association, sponsorship or approval by or between that which is incidentally depicted and Sweet Spot Co., Ltd. or its client. this listing shall not be deemed an offer to lease, sublease or sell such property; and, in the event of any transaction for such property, no commission shall be earned by or payable to any cooperating broker except if otherwise provided pursuant to the express terms, rates and conditions of Sweet Spot Co., Ltd. agreement with its principal, if, as and when such commission (if any) is actually received from such principal.
(A copy of the rates and conditions referred to above with respect to this property is available upon request.)

[sweetspot]

(주)스위트스팟 서울특별시 강남구 테헤란로 507, 12층 | 대표번호 02-6951-0765 | 팩스 02-553-0742